

Pioneer

X-CM31-K/-W/-T/-R

CD Receiver System | Micro chaîne CD | Sistema receptor de CD |
CD-Receiversystem | Sistema CD con amplificatore |
CD Receiver System | Система ресивера CD



ME06

Discover the benefits of registering your product online at
<http://www.pioneer.co.uk> (or **<http://www.pioneer.eu>**).

Découvrez les nombreux avantages offerts en enregistrant
votre produit en ligne maintenant sur

<http://www.pioneer.fr> (ou **<http://www.pioneer.eu>**).

Bitte nutzen Sie die Möglichkeit zur Registrierung Ihres
Produktes unter **<http://www.pioneer.de>** (oder

<http://www.pioneer.eu>)

Registra il tuo prodotto su **<http://www.pioneer.it>** (o

<http://www.pioneer.eu>) e scopri subito quali vantaggi puoi
ottenere!

Ontdek nu de voordelen van online registratie! Registreer uw
Pioneer product via **<http://www.pioneer.nl>** -

<http://www.pioneer.be> (of **<http://www.pioneer.eu>**)

Registre su producto en **<http://www.pioneer.es>** (o en

<http://www.pioneer.eu>) Descubra los beneficios de
registrarse on-line:

Зарегистрируйте Ваше изделие на

<http://www.pioneer-rus.ru> (или **<http://www.pioneer.eu>**).

Ознакомьтесь с преимуществами регистрации в Интернет



Operating Instructions

Mode d'emploi

Bedienungsanleitung

Istruzioni per l'uso

Handleiding

Manual de instrucciones

Инструкции по эксплуатации

Made for



iPod



iPhone



iPad

IMPORTANT



The lightning flash with arrowhead symbol, within an equilateral triangle, is intended to alert the user to the presence of uninsulated "dangerous voltage" within the product's enclosure that may be of sufficient magnitude to constitute a risk of electric shock to persons.

CAUTION

RISK OF ELECTRIC SHOCK
DO NOT OPEN

CAUTION:
TO PREVENT THE RISK OF ELECTRIC SHOCK, DO NOT REMOVE COVER (OR BACK). NO USER-SERVICEABLE PARTS INSIDE. REFER SERVICING TO QUALIFIED SERVICE PERSONNEL.



The exclamation point within an equilateral triangle is intended to alert the user to the presence of important operating and maintenance (servicing) instructions in the literature accompanying the appliance.

D3-4-2-1-1_A1_En

WARNING

This equipment is not waterproof. To prevent a fire or shock hazard, do not place any container filled with liquid near this equipment (such as a vase or flower pot) or expose it to dripping, splashing, rain or moisture.

D3-4-2-1-3_A1_En

WARNING

Before plugging in for the first time, read the following section carefully.

The voltage of the available power supply differs according to country or region. Be sure that the power supply voltage of the area where this unit will be used meets the required voltage (e.g., 230 V or 120 V) written on the rear panel.

D3-4-2-1-4*_A1_En

WARNING

To prevent a fire hazard, do not place any naked flame sources (such as a lighted candle) on the equipment.

D3-4-2-1-7a_A1_En

Operating Environment

Operating environment temperature and humidity:
+5 °C to +35 °C (+41 °F to +95 °F); less than 85 %RH (cooling vents not blocked)

Do not install this unit in a poorly ventilated area, or in locations exposed to high humidity or direct sunlight (or strong artificial light)

D3-4-2-1-7c*_A1_En

This product is for general household purposes. Any failure due to use for other than household purposes (such as long-term use for business purposes in a restaurant or use in a car or ship) and which requires repair will be charged for even during the warranty period.

K041_A1_En

VENTILATION CAUTION

When installing this unit, make sure to leave space around the unit for ventilation to improve heat radiation (at least 25 cm at top, 15 cm at rear, and 5 cm at each side).

WARNING

Slots and openings in the cabinet are provided for ventilation to ensure reliable operation of the product, and to protect it from overheating. To prevent fire hazard, the openings should never be blocked or covered with items (such as newspapers, table-cloths, curtains) or by operating the equipment on thick carpet or a bed.

D3-4-2-1-7b*_A1_En

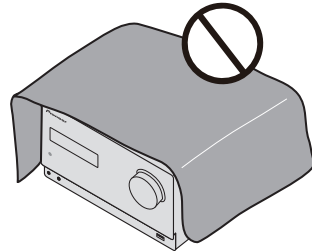

CAUTION

This product is a class 1 laser product classified under the Safety of Laser products, IEC 60825-1:2007.

CLASS 1 LASER PRODUCT

D58-5-2-2a_A1_En

WARNING

Store small parts out of the reach of children and infants. If accidentally swallowed, contact a doctor immediately.

Information for users on collection and disposal of old equipment and used batteries

(Symbol for equipment)



These symbols on the products, packaging, and/or accompanying documents mean that used electrical and electronic products and batteries should not be mixed with general household waste.

For proper treatment, recovery and recycling of old products and used batteries, please take them to applicable collection points in accordance with your national legislation.

(Symbol examples for batteries)



By disposing of these products and batteries correctly, you will help to save valuable resources and prevent any potential negative effects on human health and the environment which could otherwise arise from inappropriate waste handling.

For more information about collection and recycling of old products and batteries, please contact your local municipality, your waste disposal service or the point of sale where you purchased the items.

These symbols are only valid in the European Union.

For countries outside the European Union:

If you wish to discard these items, please contact your local authorities or dealer and ask for the correct method of disposal.



K058a_A1_En

If the AC plug of this unit does not match the AC outlet you want to use, the plug must be removed and appropriate one fitted. Replacement and mounting of an AC plug on the power supply cord of this unit should be performed only by qualified service personnel. If connected to an AC outlet, the cut-off plug can cause severe electrical shock. Make sure it is properly disposed of after removal. The equipment should be disconnected by removing the mains plug from the wall socket when left unused for a long period of time (for example, when on vacation).

D3-4-2-2-1a_A1_En

CAUTION

The **STANDBY/ON** switch on this unit will not completely shut off all power from the AC outlet. Since the power cord serves as the main disconnect device for the unit, you will need to unplug it from the AC outlet to shut down all power. Therefore, make sure the unit has been installed so that the power plug can be easily unplugged from the AC outlet in case of an accident. To avoid fire hazard, the power cord should also be unplugged from the AC outlet when left unused for a long period of time (for example, when on vacation).

D3-4-2-2-2a*_A1_En

POWER-CORD CAUTION

Handle the power cord by the plug. Do not pull out the plug by tugging the cord and never touch the power cord when your hands are wet as this could cause a short circuit or electric shock. Do not place the unit, a piece of furniture, etc., on the power cord, or pinch the cord. Never make a knot in the cord or tie it with other cords. The power cords should be routed such that they are not likely to be stepped on. A damaged power cord can cause a fire or give you an electrical shock. Check the power cord once in a while. When you find it damaged, ask your nearest PIONEER authorized service center or your dealer for a replacement.

5002*_A1_En

Thank you for buying this Pioneer product.

Please read through these operating instructions so that you will know how to operate your model properly. After you have finished reading the instructions, put them in a safe place for future reference.

Contents

01 Before you start

What's in the box	5
Loading the batteries in the remote control	5
Using the remote control	5

02 Part names and functions

Remote control	6
Speaker system	7
Attaching the Non-skid pads	7
Front panel	8
Top panel	9

03 Connections

Speaker connection	10
Connecting a TV	10
Connecting antennas	11
Using external antennas	11
Plugging in	11

04 Getting started

To turn the power on	12
Setting the clock	12
General control	12
Input function	12
Display brightness control	12
Volume auto set-in	12
Volume control	12
Muting	12
Sound controls	13
Equaliser	13
P.bass control	13
Bass/treble control	13
Setting the wake-up timer	13
Calling the wake-up timer	14
Cancelling the wake-up timer	14
Using the wake-up timer	14
Using the sleep timer	14
Using Headphones	14

05 iPod/iPhone/iPad playback

Confirming what iPod/iPhone/iPad models are supported	15
Connecting your iPod/iPhone/iPad	15
Connecting iPod/iPhone to the top panel	15
Connecting iPad using supplied stand	16
Watching iPod/iPhone videos on your TV	16
Playing iPod/iPhone	16
Playing iPad	17

06 Disc playback

Playing discs or files	18
Advanced CD or MP3/WMA disc playback	19
Direct track search	19
Repeat play	19
Random play	19
Programmed play (CD or MP3/WMA)	20
About downloading MP3/WMA	20
About folder playback order	20
Specify the folder to play	21
Switch the display contents	21

07 USB playback

Playing USB storage devices	22
Repeat play	22
Random play	22
Specify the folder to play	23
Playing in the desired order (Programmed Play)	23

08 Using the tuner

Listening to the radio broadcasts	24
Tuning	24
Saving station presets	24
To recall a memorised station	25
To scan the preset stations	25
To erase entire preset memory	25
Using the Radio Data System (RDS)	25
An introduction to RDS	25
Searching for RDS programs	25
Information provided by RDS	26
Using the Auto Station program Memory (ASPM)	26
Notes for RDS operation	26

09 Other connections

Connecting auxiliary components	27
---------------------------------	----

10 Additional information

Troubleshooting	28
Playable discs and formats	30
Regarding copy protected CDs	30
Supported audio file formats	30
Cautions on use	30
When moving this unit	30
Place of installation	30
Do not place objects on this unit	31
About condensation	31
Cleaning the product	31
Cleaning the lens	31
Handling discs	31
Storing	31
Cleaning discs	31
About specially shaped discs	31
About iPod/iPhone/iPad	32
Restoring all the settings to the defaults	32
Specifications	33

Chapter 1: Before you start

What's in the box

Please confirm that the following accessories are in the box when you open it.

- Remote Control
- Power cord
- AM antenna cable
- FM wire antenna
- AAA batteries (R03) x 2
- Non-skid pads x 8
- iPad stand
- Warranty card
- Operating instructions (this document)

Loading the batteries in the remote control

1 Open the rear lid and load the batteries as illustrated below.

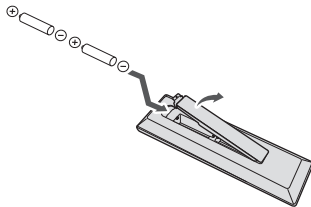

2 Close the rear lid.

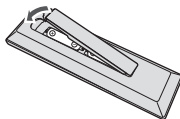

CAUTION

- Do not use any batteries other than the ones specified. Also, do not use a new battery together with an old one.
- When loading the batteries into the remote control, set them in the proper direction, as indicated by the polarity marks (+ and -).
- Do not heat batteries, disassemble them, or throw them into flames or water.

- Batteries may have different voltages, even if they are the same size and shape. Do not use different types of batteries together.
- To prevent leakage of battery fluid, remove the batteries if you do not plan to use the remote control for a long period of time (1 month or more). If the fluid should leak, wipe it carefully off the inside of the case, then insert new batteries. If a battery should leak and the fluid should get on your skin, flush it off with large quantities of water.
- When disposing of used batteries, please comply with governmental regulations or environmental public institution's rules that apply in your country/area.
- **WARNING**
Do not use or store batteries in direct sunlight or other excessively hot place, such as inside a car or near a heater. This can cause batteries to leak, overheat, explode or catch fire. It can also reduce the life or performance of batteries.

Using the remote control

The remote has a range of about 7 m at an angle of about 30° from the remote sensor.

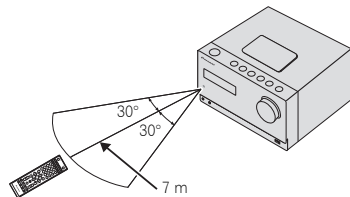

Keep in mind the following when using the remote control:

- Make sure that there are no obstacles between the remote and the remote sensor on the unit.
- Remote operation may become unreliable if strong sunlight or fluorescent light is shining on the unit's remote sensor.
- Remote controllers for different devices can interfere with each other. Avoid using remotes for other equipment located close to this unit.
- Replace the batteries when you notice a fall off in the operating range of the remote.

Chapter 2:

Part names and functions

Remote control

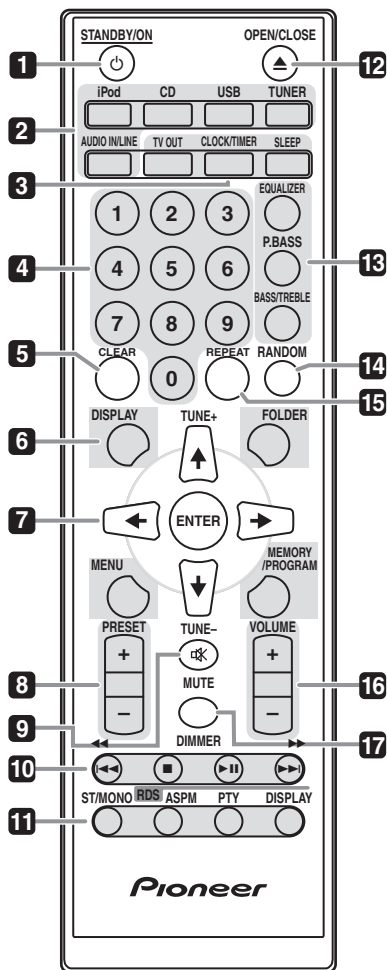
**1** **STANDBY/ON**

Switches the receiver between standby and on (page 18).

2 **Input function buttons**

Use to select the input source to this receiver (page 18).

3 **CD Receiver control buttons**
TV OUT

Setting iPod/iPhone video on/off.

CLOCK/TIMER

Use for setting the clock, as well as for setting and checking the timers (page 12).

SLEEP

See *Using the sleep timer* on page 14.

4 **Numeric buttons (0 to 9)**

Use to enter the number (page 19).

5 **CLEAR**

Use to clear the programmed play (page 20).

6 **CD Receiver control buttons**
DISPLAY

Press to change the display for songs playing back from CD or USB (page 21).

FOLDER

Use to select the folder of the MP3/WMA disc or USB mass storage device (page 20).

MENU

Use to access the menu.

MEMORY/PROGRAM

Use to memory or program the MP3/WMA disc (page 20).

7 **↑/↓/←/→ (TUNE +/-), ENTER**

Use to select/switch system settings and modes, and to confirm actions.

Use **TUNE +/-** can be used to find radio frequencies (page 24).

8 **PRESET control buttons**

Use to select preset radio stations (page 24).

9 **MUTE**

Mutes/unmutes the sound (page 12).

10 **Playback control buttons**

Use to control each function after you have selected it using the input function buttons (page 18).

11 Tuner control buttons ST/MONO

Use to switch the sound mode between stereo and monaural. (page 24)

RDS ASPM

Use to search for RDS Auto station program memory (page 25).

RDS PTY

Use to search for RDS program types (page 25).

RDS DISPLAY

Press to change the RDS display for information mode (page 25).

12 OPEN/CLOSE

Use to open or close the disc tray (page 18).

13 Sound control buttons

Adjust the sound quality (page 13).

14 RANDOM

Press to randomize order play setting from a CD, iPod or USB (page 19).

15 REPEAT

Press to change the repeat play setting from a CD, iPod or USB (page 19).

16 Volume control buttons

Use to set the listening volume (page 12).

17 DIMMER

Dims or brightens the display. The brightness can be controlled in four steps (page 12).

Speaker system

- 1 Tweeter
- 2 Woofer
- 3 Bass Reflex Duct

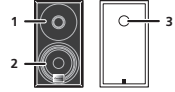

Important

Speaker grille cannot be removed.

Attaching the Non-skid pads

Apply the accessory non-skid pads to the bottom surfaces of the speakers.

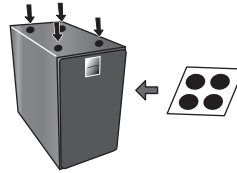

Important

Use the speaker is usually in an upright position.

Front panel

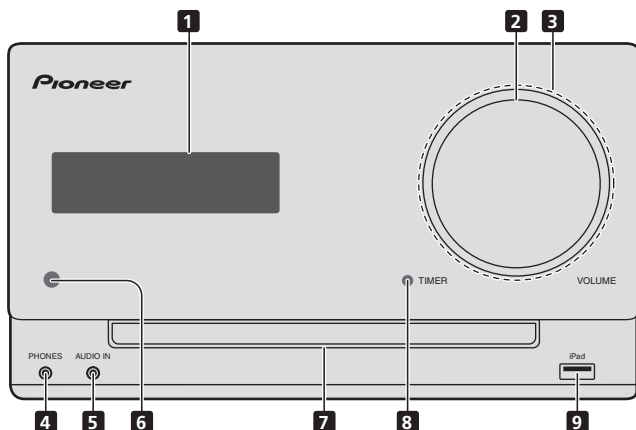

1 Main display

2 Volume control

Use to set the listening volume (page 12).

3 Volume illumination

Light when the power on.

4 Headphone socket

Use to connect headphones. When the headphones are connected, there is no sound output from the speakers.

5 AUDIO IN socket

Use to connect an auxiliary component using a stereo minijack cable (page 27).

6 Remote sensor

Receives the signals from the remote control.

7 Disc tray

Place the disc, label side up (page 18).

8 TIMER indicator

Lights when the receiver is power off with timer setting.

9 USB terminal

Use to connect your USB mass storage device or Apple iPod/iPhone/iPad as an audio source (page 22).

Top panel

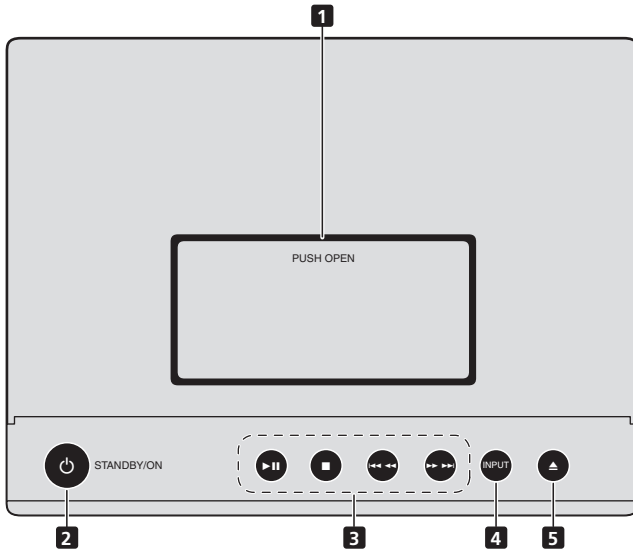

1 iPod/iPhone connector port

To connect the iPod/iPhone, press the PUSH OPEN tab (page 15).

2 STANDBY/ON

Switches the receiver between standby and on (page 18).

3 Playback control buttons

Selects the desired track or file to be played back. Use to stop the playback. Stops playback or resumes playback from the pause point.

4 INPUT

Selects the input source.

5 Disc tray open/close button

Use to open or close the disc tray (page 18).

Chapter 3:

Connections

⚠ CAUTION

- Be sure to turn off the power and unplug the power cord from the power outlet whenever making or changing connections.
- Connect the power cord after all the connections between devices have been completed.

Speaker connection

To connect the speaker cord to the connector, insert into the speaker connector of the rear of the receiver.

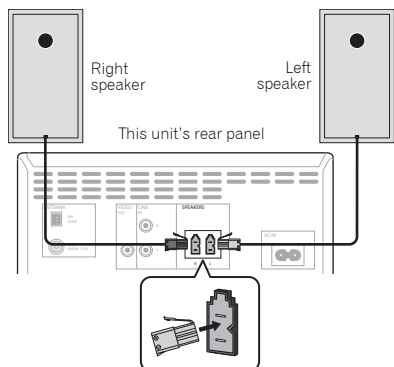
**⚠ CAUTION**

- These speaker terminals carry **HAZARDOUS LIVE voltage**. To prevent the risk of electric shock when connecting or disconnecting the speaker cables, disconnect the power cord before touching any uninsulated parts.
- Do not connect any speakers other than those supplied to this system.
- Do not connect the supplied speakers to any amplifier other than the one supplied with this system. Connection to any other amplifier may result in malfunction or fire.
- Do not attach these speakers to the wall or ceiling. They may fall off and cause injury.
- These speakers are magnetically shielded. However, depending on the installation location, color distortion may occur if the speaker system is installed extremely close to the screen of a television set. If this happens, turn off the television set, and then turn it on after 15 to 30 minutes. If the problem persists, move the speaker system away from the television set.

Connecting a TV

- When an iPod/iPhone is connected to this unit, the TV output setting of iPod/iPhone is automatically set to 'ON'.

📌 Note

- Some iPod allow the TV output setting to be changed while connected.
- When the iPod/iPhone is disconnected from this unit, the iPod/iPhone's TV output setting returns to its original state.

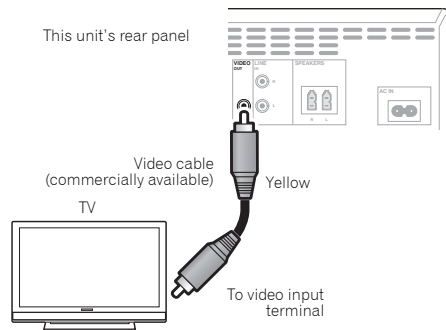

Connecting antennas

Connect the AM loop antenna and the FM wire antenna as shown below. To improve reception and sound quality, connect external antennas (see *Using external antennas* below).

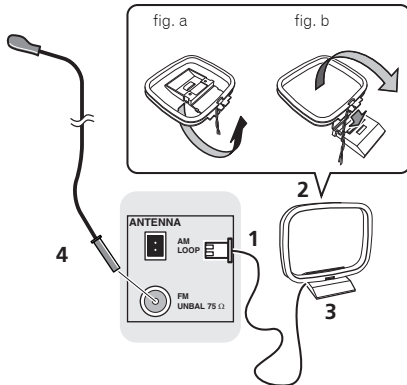

1 Connect the AM antenna wires.

Holding the connector to connect.

2 Fix the AM loop antenna to the attached stand.

To fix the stand to the antenna, bend in the direction indicated by the arrow (fig. a) then clip the loop onto the stand (fig. b).

3 Place the AM antenna on a flat surface and in a direction giving the best reception.

4 Connect the FM wire antenna into the FM antenna socket.

For best results, extend the FM antenna fully and fix to a wall or door frame. Don't drape loosely or leave coiled up.

Using external antennas

To improve FM reception

Use a PAL connector (not supplied) to connect an external FM antenna.

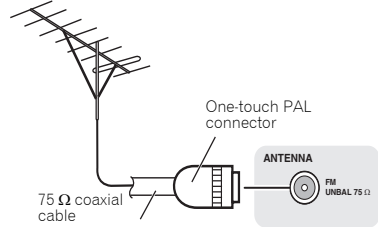

Plugging in

Before making or changing the connections, switch off the power and disconnect the power cord from the AC outlet. After you've finished making all connections, plug the unit into an AC outlet.

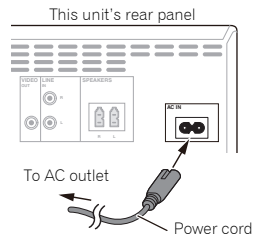

⚠ CAUTION

- Do not use any power cord other than the one supplied with this unit.
- Do not use the supplied power cord for any purpose other than that described below.

Chapter 4:

Getting started

To turn the power on

Press the **STANDBY/ON** to turn the power on.

After use:

Press the **STANDBY/ON** to enter the power stand-by mode.

**Note**

- In standby mode, if iPod/iPhone/iPad is connected, the unit turns charge mode.

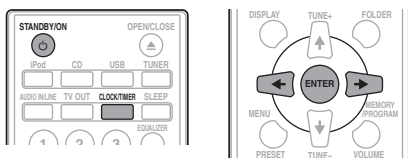
Setting the clock

- Press **STANDBY/ON** to turn the power on.
- Press **CLOCK/TIMER** on the remote control. "CLOCK" is shown on the main display.
- Press **ENTER**.
- Press **←/→** to set the day, then press **ENTER**.
- Press **←/→** to set the hour, then press **ENTER**.
- Press **←/→** to set the minute, then press **ENTER** to confirm.

To confirm the time display:

Press the **CLOCK/TIMER**. The time display will appear for about 10 seconds.

To readjust the clock:

Perform "Setting the clock" from step 1.

**Note**

- When power supply is restored after unit is plugged in again or after a power failure, reset the clock.

General control**Input function**

When the **INPUT** on main unit is pressed, the current function will change to different mode. Press the **INPUT** repeatedly to select desired function.

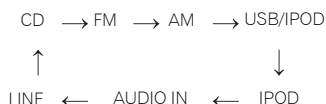
**Display brightness control**

Press **DIMMER** to dims the display brightness. The brightness can be controlled in four steps.

Volume auto set-in

If you turn off and on the main unit with the volume set to 17 or higher, the volume starts at 16 and sets in to the last set level.

Volume control

Turn the volume knob towards **VOLUME** (on main unit) or press **VOLUME +/-** (on remote control) to increase or decrease the volume.

CAUTION

- The sound level at a given volume setting depends on speaker efficiency, location, and various other factors. It is advisable to avoid exposure to high volume levels. Do not turn the volume on to full at switch on. Listen to music at moderate levels. Excessive sound pressure from earphones and headphones can cause hearing loss.

Muting

The volume is muted temporarily when pressing the **MUTE** on the remote control. Press again to restore the volume.

Sound controls

Equalizer

When the **EQUALIZER** is pressed, the current mode setting will be displayed. To change to a different mode, press the **EQUALIZER** repeatedly until the desired sound mode appears.

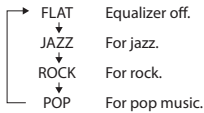

P.bass control

When the power is first turned on, the unit will enter the P.bass mode which emphasises the bass frequencies. To cancel the P.bass mode, press the **P.BASS** on the remote control.

Bass/treble control

Press the **BASS/TREBLE**, then press **←/→** to adjust the bass or treble.

Note

EQUALIZER, **P.BASS** and **BASS/TREBLE**, the simultaneous operation is not possible. Among the features of these three, one feature will only work you have selected.

If you select one of three functions, features that are not selected will be set as follows.

1 If you change the settings of P.BASS (ON/OFF).

- **EQUALIZER** : FLAT
- **BASS/TREBLE** : BASS=0, TREBLE=0

2 If you change the settings of EQUALIZER.

- **P.BASS** : OFF
- **BASS/TREBLE** : BASS=0, TREBLE=0

3 If you change the settings of BASS/TREBLE.

- **P.BASS** : OFF
- **EQUALIZER** : FLAT

Setting the wake-up timer

Used to change the existing timer setting, or to set a new timer.

1 Press **⏻** **STANDBY/ON** **to turn the power on.**

2 Press and hold **CLOCK/TIMER**.

3 Press **←/→** **to select "ONCE" or "DAILY", then press** **ENTER**.

ONCE – Once timer play works for one time only at a preset time.

DAILY – Daily timer play works at the same preset time and days of week.

4 Press **←/→** **to select "TIMER SET", then press** **ENTER**.

5 Press **←/→** **to select the timer playback source, then press** **ENTER**.

- **CD, FM, AM, USB/IPOD, IPOD, AUDIO IN** and **LINE** can be selected as the playback source.

6 Press **←/→** **to select the timer day, then press** **ENTER**.

7 Press **←/→** **to set the hour, then press** **ENTER**.

8 Press **←/→** **to set the minute, then press** **ENTER**.

- Set the time to finish as in steps 7 and 8 above.

9 Adjust the volume press **VOLUME +/-**, **then press** **ENTER**.

10 Press **⏻** **STANDBY/ON** **to enter the power standby mode.**

- The **TIMER** indicator lights up.

Calling the wake-up timer

It can be used to re-use an existing timer setting.

- 1 As well as steps 1 through 3 in "Setting the wake-up timer".
- 2 Press **←/→** to select "TIMER ON", then press **ENTER**.

Cancelling the wake-up timer

It can be used to turn off the timer setting.

- 1 As well as steps 1 through 3 in "Setting the wake-up timer".
- 2 Press **←/→** to select "TIMER OFF", then press **ENTER**.

Using the wake-up timer

- 1 Press **⏻** STANDBY/ON to turn the power off.
- 2 At the wake-up time, this unit will turn on automatically and play the selected input function.

Note

- If at the wake-up time iPod/iPhone/iPad is not connected to this unit or a disc is not inserted, this unit will be turned to on and not play back the track.
- Some discs may not be played automatically at the wake-up time.
- If you set the timer, take one minute or more between the start and end time.

Using the sleep timer

The sleep timer switches off the unit after a specified time so you can fall asleep without worrying about it.

- 1 Press **SLEEP** repeatedly to select a switch off time.

Choose between 10 min, 20 min, 30 min, 60 min, 90 min, 120 min, 150 min, 180 min or OFF. The newly set value displays for 3 seconds, and then the setting is completed.

Note

- The sleep timer can be set by pressing **SLEEP** while the remaining time is displayed.

Using Headphones

Connect to the jack plug of the headphones.

When the headphones are connected, there is no sound output from the speakers.

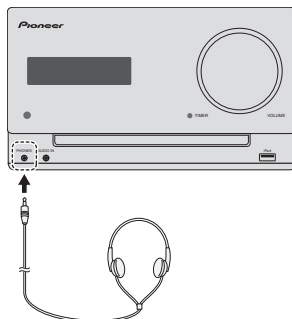

- Do not turn the volume on to full at switch on and listen to music at moderate levels. Excessive sound pressure from earphones and headphones can cause hearing loss.
- Before plugging in or unplugging the headphone, reduce the volume.
- Be sure your headphone has a 3,5 mm diameter plug and impedance between 16 Ω and 50 Ω . The recommended impedance is 32 Ω .
- Audio from the iPod/iPhone/iPad cannot be heard via the headphones connected to the unit. "HP MUTE" will be displayed if you connect the headphones when the iPod/iPhone/iPad function is selected.

Chapter 5:

iPod/iPhone/iPad playback

Merely by connecting your iPod/iPhone/iPad to this unit, you can enjoy high-quality sound from your iPod/iPhone/iPad. This unit can also be connected to a television set, letting you view videos from your iPod/iPhone. Playback setting for iPod/iPhone/iPad music can be performed from this unit or the iPod/iPhone/iPad itself.

- To connect a TV, see page 10.

Confirming what iPod/iPhone/iPad models are supported

The iPod/iPhone/iPad playable on this unit are shown below.

- Video output for iPod/iPhone is only compatible when connected to the Dock connector.

iPod/iPhone/iPad	Dock connector (Audio/Video)	USB Terminal (Audio only)
iPod nano 3G/4G/5G/6G*	✓	✓
iPod touch 1G/2G/3G/4G	✓	✓
iPhone	✓	✓
iPhone 3G	✓	✓
iPhone 3GS	✓	✓
iPhone 4	✓	✓
iPhone 4S	✓	✓
iPad	—	✓
iPad 2	—	✓

* iPod nano 6G is supports audio only.

Note

- Pioneer does not guarantee that this unit plays iPod/iPhone/iPad models other than the ones specified.
- Some functions may be restricted depending on the model or software version.
- iPod/iPhone/iPad is licensed for reproduction of non-copyrighted materials or materials the user is legally permitted to reproduce.
- Features such as the equalizer cannot be controlled using this system, and we recommend switching the equalizer off before connecting.
- Pioneer cannot under any circumstances accept responsibility for any direct or indirect loss arising from any inconvenience or loss of recorded material resulting from iPod/iPhone/iPad failure.
- For detailed instructions on using the iPod/iPhone/iPad, please refer to the manual supplied with the iPod/iPhone/iPad.

- This system has been developed and tested for the software version of iPod/iPhone/iPad indicated on the website of Pioneer (<http://pioneer.jp/homeav/support/ios/eu/>).
- Installing software versions other than indicated on the website of Pioneer to your iPod/iPhone/iPad may result in incompatibility with this system.
- This unit cannot be used to record CD, tuner or other content on an iPod/iPhone/iPad.

Connecting your iPod/iPhone/iPad

⚠ CAUTION

- When connecting iPod/iPhone devices, always use the dock adapter provided with iPod/iPhone devices, or a commercially available adapter designed to support iPod/iPhone. The iPod/iPhone cannot be connected without a dock adapter; attempting to connect an iPod/iPhone without it will cause damage or malfunction.
- An iPod/iPhone universal dock adapter is not supplied with this unit.

📌 Important

- If you are mounting the protective cover of a commercially available iPod/iPhone/iPad, you may not be able to connect iPod/iPhone/iPad to this unit.

Connecting iPod/iPhone to the top panel

1 Press the PUSH OPEN.

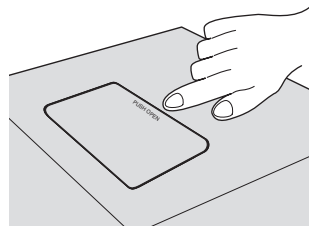

- 2 Open the iPod/iPhone connector port.

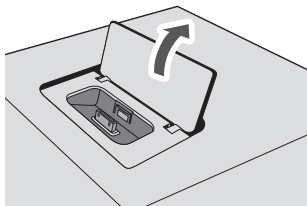

- 3 Connect your iPod/iPhone.

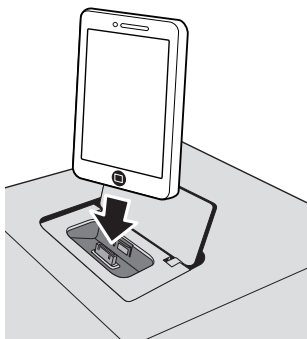

- When iPod/iPhone is not connected to the unit, close the iPod/iPhone connector port firmly.

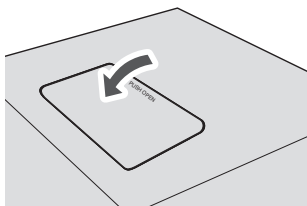

Connecting iPod/iPhone/iPad using supplied stand

- 1 Connect the iPod/iPhone/iPad cable to the unit.
- 2 From the bottom of the connector to through the iPod/iPhone/iPad cable, and connect it to iPod/iPhone/iPad.

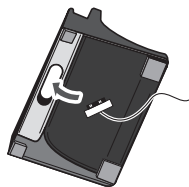

- 3 Set up to stand the iPod/iPhone/iPad.

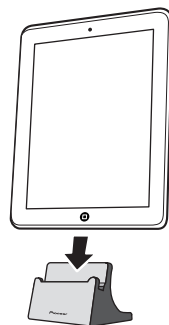

Watching iPod/iPhone videos on your TV

To watch iPod/iPhone videos on a television, connect it using a video cable. When an iPod/iPhone is connected to this unit, the TV output setting of the iPod/iPhone is automatically set to 'ON'.

⚠ CAUTION

- Before making or changing the connections, switch off the power and disconnect the power cord from the power outlet. Plugging in should be the final step.

📌 Note

- For detailed instructions on using the iPod/iPhone, please refer to the manual supplied with the iPod/iPhone.
- Some iPods allow the TV output setting to be changed while connected.

- When the iPod/iPhone is disconnected from this unit, the iPod/iPhone's TV output setting returns to its original state.

Playing iPod/iPhone

1 Connect your iPod/iPhone.

- If an iPod/iPhone is connected when this unit is on, playback of the iPod/iPhone will not begin.

2 Press iPod or USB as the input source.

"IPOD" or "USB/IPOD" is shown on the main display.

3 When the recognition is completed, will begin playing automatically.

- The available iPod/iPhone playback control by this unit is **▶||, ◀◀ ◀◀, ▶▶ ▶▶**.
- In the following case, operate your iPod/iPhone directly:
 - Searching a file by artist name or genre.
 - Playing in the repeat or random mode.
 - Watching videos stored in iPod/iPhone on your television.

- Check whether the iPod/iPhone/iPad is supported by this unit.
- Reconnect the iPod/iPhone/iPad to the unit. If this doesn't seem to work, try resetting your iPod/iPhone/iPad.
- Check the iPod/iPhone/iPad software is supported by this unit.

If the iPod/iPhone/iPad cannot be operated, check the following items:

- Is the iPod/iPhone/iPad connected correctly? Reconnect the iPod/iPhone/iPad to the unit.
- Is the iPod/iPhone/iPad experiencing a hangup? Try resetting the iPod/iPhone/iPad, and reconnect it to the unit.

Playing iPad

1 Connect your iPad.

- If an iPad is connected when this unit is on, playback of the iPad will not begin.

2 Press USB as the input source.

"USB/IPOD" is shown on the main display.

3 When the recognition is completed, will begin playing automatically.

- The available iPad playback control by this unit is **▶||, ◀◀ ◀◀, ▶▶ ▶▶**.
- In the following case, operate your iPad directly:
 - Searching a file by artist name or genre.
 - Playing in the repeat or random mode.

CAUTION

- When your iPod/iPhone/iPad is connected to this unit and you wish to operate the iPod/iPhone/iPad directly, be sure to steady the iPod/iPhone/iPad with the other hand to prevent malfunctions due to faulty contacts.

Note

- For detailed instructions on using the iPod/iPhone/iPad, please refer to the manual supplied with the iPod/iPhone/iPad.
- iPod/iPhone/iPad recharging occurs whenever an iPod/iPhone/iPad is connected to this unit. (This function is supported in standby mode as well.)
- When input is switched from iPod to another function, iPod/iPhone/iPad playback is temporarily stopped.

Important

If this unit cannot play your iPod/iPhone/iPad, perform the following troubleshooting checks:

Chapter 6:

Disc playback

This system can play back a standard CD, CD-R/RW in the CD format and CD-R/RW with MP3 or WMA files, but cannot record on them. Some audio CD-R and CD-RW discs may not be playable due to the state of the disc or the device that was used for recording.

MP3:

MP3 is a form of compression. It is an acronym which stands for MPEG Audio Layer 3. MP3 is a type of audio code which is processed by significant compression from the original audio source with very little loss in sound quality.

- This system supports MPEG-1/2 Audio Layer 3 (Sampling rates: 8 kHz to 48 kHz; Bit rates: 64 kbps to 384 kbps).
- During VBR file playback, time counter in the display may differ from its actual playback time.

WMA:

WMA (Windows Media Audio) files are Advanced System Format files that include audio files which are compressed with Windows Media Audio codec. WMA is developed by Microsoft as an audio format file for Windows Media Player.

- This system supports WMA (Sampling rates: 32 kHz/44.1 kHz/48 kHz; Bit rates: 64 kbps to 320 kbps).
- During VBR file playback, time counter in the display may differ from its actual playback time.

Playing discs or files

- 1 Press **⏻** STANDBY/ON to turn the power on.
- 2 Press **CD** on the remote control or **INPUT** repeatedly on the main unit to select **CD** input.
- 3 Press **▲** OPEN/CLOSE to open the disc tray.
- 4 Place the disc on the disc tray, label side up.

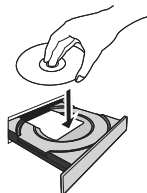

- 5 Press **▲** OPEN/CLOSE to close the disc tray.
- 6 Press **▶||** to start playback.

After the last track is played, the unit will stop automatically.

⚠ CAUTION

- Do not place two discs in one disc tray.
- Do not play discs of special shapes (heart, octagon, etc). It may cause malfunctions.
- Do not push the disc tray whilst it is moving.
- If the power fails whilst the tray is open, wait until the power is restored.
- Be sure to place 8 cm disc in the middle of the disc tray.

📝 Note

- Due to the structure of the disc information, it takes longer to read an MP3/WMA disc than a normal CD (approximately 20 to 90 seconds).
- When the beginning of the first track is reached during fast reverse, the unit will enter the playback mode (only for CD).
- Rewritable multi-session discs with unfinished writing, can still be played.
- If TV or radio interference occurs during CD operation, move the unit away from the TV or radio.

⚙ Tip

- When no operation has done in CD mode and the audio file is not played for more than 15 minutes, the power will automatically turn off.

Various disc functions

Function	Main unit	Remote control	Operation
Play			Press in the stop mode.
Stop			Press in the playback mode.
Pause			Press in the playback mode. Press ▶ to resume playback from the paused point.
Track up/down			Press in the playback or stop mode. If you press the button in the stop mode, press ▶ to start the desired track.
Fast forward/reverse			Press and hold down in the playback mode. Release the button to resume playback.

Advanced CD or MP3/WMA disc playback

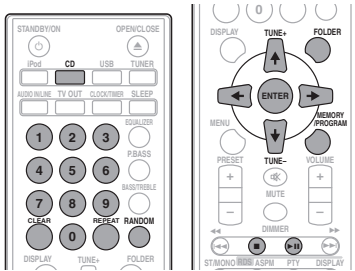

Direct track search

By using the numeric buttons, the desired tracks on the current disc can be played.

Use the numeric buttons on the remote control to select the desired track whilst playing the selected disc.

Note

- A track number higher than the number of tracks on the disc cannot be selected.

To stop playback:

Press **■**.

Repeat play

Repeat play can play one track, all tracks or a programmed sequence continuously.

To repeat one track:

Press **REPEAT** repeatedly until "RPT ONE" appears. Press **ENTER**.

To repeat all tracks:

Press **REPEAT** repeatedly until "RPT ALL" appears. Press **ENTER**.

To repeat desired tracks:

Perform steps 1 - 5 in "Programmed play" section on next page and then press **REPEAT** repeatedly until "RPT ALL" appears. Press **ENTER**.

To cancel repeat play:

Press **REPEAT** repeatedly until "RPT OFF" appears. Press **ENTER**.

Note

- After performing repeat play, be sure to press **■**. Otherwise, the disc will play continuously.
- During repeat play, random play is not possible.

Random play

The tracks on the disc can be played in random order automatically.

To random play all tracks:

Press **RANDOM** repeatedly until "RDM ON" appears. Press **ENTER**.

To cancel random play:

Press **RANDOM** repeatedly until "RDM OFF" appears. Press **ENTER**.

Note

- If you press the **▶▶** during random play, you can move to the track selected next by the random operation. On the other hand, the **◀◀** does not allow you to move to the previous track. The beginning of the track being played will be located.
- In random play, the unit will select and play tracks automatically. (You cannot select the order of the tracks.)
- During random play, repeat play is not possible.

Programmed play (CD or MP3/WMA)

You can choose up to 32 selections for playback in the order you like.

- 1 Whilst in the stop mode, press **MEMORY/PROGRAM** on the remote control to enter the programming save mode.
- 2 Press **◀▶** or the numeric buttons on the remote control to select the desired tracks.
- 3 Press **ENTER** to save folder and track number.
- 4 Repeat steps 2 - 3 for other folder/tracks. Up to 32 tracks can be programmed.
 - If you want to check the programmed tracks, press **MEMORY/PROGRAM**.
 - If you make a mistake, the last programmed tracks will be canceled by pressing **CLEAR**.
- 5 Press **▶II** to start playback.

To cancel the programmed play mode:

To cancel the programmed play, press twice **■** on the remote control. The display will show "PRG CLR" and all the programmed contents will be cleared.

Adding tracks to the program:

Press the **MEMORY/PROGRAM**. Then follow steps 2 - 3 to add tracks.



Note

- When a disc is ejected, the program is automatically cancelled.
- If you press the **⏻** **STANDBY/ON** to enter the standby mode or change the function from **CD** to another, the programmed selections will be cleared.
- During the program operation, random play is not possible.

About downloading MP3/WMA

There are many music sites on the internet that you can download MP3/WMA music files. Follow the instructions from the website on how to download the music files. You can then play back these downloaded music files by burning them to a CD-R/RW disc.

- Your downloaded song/files are for personal use only. Any other usage of the song without owner's permission, is against the law.

About folder playback order

If MP3/WMA files are recorded in several folders, a folder number will be set to each folder automatically.

These folders can be selected by the **FOLDER** on the remote control. If there is no supported file formats inside the selected folder, the folder is skipped and the next folder will be selected.

Example: How to set folder number if MP3/WMA format files are recorded as below figure.

- 1 **ROOT** folder is set as folder 1.
- 2 As for folders inside **ROOT** folder (**Folder A** and **Folder B**), the folder which is recorded earlier on the disc will be set as folder 2 and folder 3.
- 3 As for folder inside **Folder A** (**Folder C** and **Folder D**), the folder which is recorded earlier on the disc will be set as folder 4 and folder 5.
- 4 **Folder E** that is inside **Folder D** will be set as folder 6.
 - The folder and file order information which is recorded on the disc depends on the writing software. There maybe possibilities that this unit will playback the files not according to our expected playback order.
 - MP3/WMA is 255 numbers of folders and 999 files inclusive of the folders which have non playable files can be read.

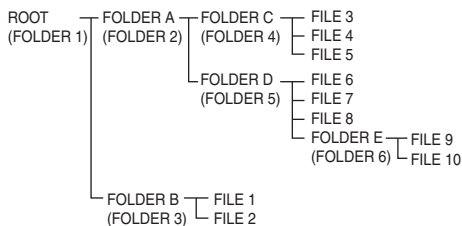

Specify the folder to play

Specify the folder to play, do the following steps.

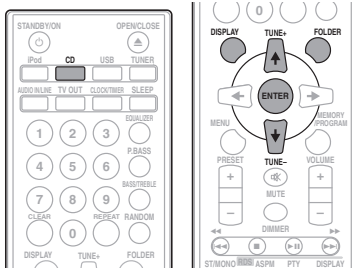

1 Press CD, and load an MP3/WMA disc.

2 Press FOLDER, and press \uparrow/\downarrow to select desired playback folder.

3 Press ENTER.

Playback will start from the first song of the selected folder.

- In case of stop, press \uparrow/\downarrow , and the folder can be selected.

Switch the display contents

1 Press DISPLAY.

If the title, artist and album name has been written to the file, that information will be displayed. (You can view this unit is only alphanumeric characters. Non- alphanumeric character are displayed in the "**").

Number of track, playback time display \rightarrow Title/Artist/Album display time display



Note

- "Copyright protected WMA file" or "Not supported playback file" can not be playback. In this case, will be skipped automatically.
- Some files, you may no information is displayed.
- Title, artist and album name, and supports only MP3.

Chapter 7:

USB playback

Playing USB storage devices

It is possible to listen to two-channel audio using the USB interface on the front of this receiver.

- Pioneer does not guarantee that any file recorded on a USB storage device will play or that power will be supplied to a USB storage device. Also note that Pioneer will accept no responsibility whatsoever for loss of files on USB storage devices caused by connection to this unit.

1 Press USB as the input source.

"USB/IPOD" is shown on the main display.

2 Connect the USB storage device.

The number of folders or files stored on the connected USB storage device appear on the main display automatically.

- This receiver does not support a USB hub.
- If iPod/iPhone/iPad is connected, the unit will begin charging.

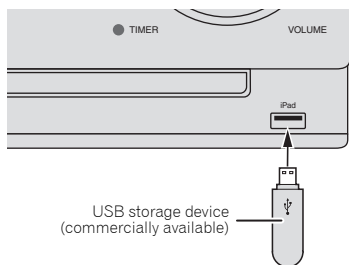

3 When the recognition is completed, press ►II to start playback.

- When changing to a different input source, stop the USB memory playback first, before changing.

4 Disconnect USB storage device from the USB terminal.

Turn the power off before removing the USB storage device.

Note

- This unit may not recognize a USB storage device, play files or supply power to a USB storage device. For details, see *When a USB storage device is connected* on page 29.
- When a USB storage device is not playing and the unit has not been operated for 15 minutes or more, the power will automatically turn off.

Repeat play

Repeat play can play one track, all tracks or a programmed sequence continuously.

To repeat one track:

Press **REPEAT** repeatedly until "RPT ONE" appears. Press **ENTER**.

To repeat all tracks:

Press **REPEAT** repeatedly until "RPT ALL" appears. Press **ENTER**.

To repeat desired tracks:

Perform steps 1 - 5 in "Programmed play" section on next page and then press **REPEAT** repeatedly until "RPT ALL" appears. Press **ENTER**.

To cancel repeat play:

Press **REPEAT** repeatedly until "RPT OFF" appears. Press **ENTER**.

Note

- After performing repeat play, be sure to press **■**. Otherwise, the file of USB storage device will play continuously.
- During repeat play, random play is not possible.

Random play

The file of USB storage device can be played in random order automatically.

To random play all tracks:

Press **RANDOM** repeatedly until "RDM ON" appears. Press **ENTER**.

To cancel random play:

Press **RANDOM** repeatedly until "RDM OFF" appears. Press **ENTER**.

Note

- If you press the ►► during random play, you can move to the track selected next by the random operation. On the other hand, the ◀◀ does not allow you to move to the previous track. The beginning of the track being played will be located.
- In random play, the unit will select and play tracks automatically. (You cannot select the order of the tracks.)
- During random play, repeat play is not possible.

Specify the folder to play

Specify the folder to play, do the following steps.

- 1 Press USB, and connect the USB storage device.**
- 2 Press FOLDER, and press ↑/↓ to select desired playback folder.**
- 3 Press ENTER.**

Playback will start from the first song of the selected folder.

- In case of stop, press ↑/↓, and the folder can be selected.

Switch the display contents

This unit can switch the information recorded in the USB storage device. For details, see *Switch the display contents* on page 21.

Playing in the desired order (Programmed Play)

This unit can play repeatedly folders stored in the USB storage device. For details, see *Programmed play (CD or MP3/WMA)* on page 20.

Chapter 8:

Using the tuner

Listening to the radio broadcasts

The following steps show you how to tune in to FM and AM radio broadcasts using the automatic (search) and manual (step) tuning functions. Once you are tuned to a station you can memorize the frequency for recall later. See *Saving station presets* below for more on how to do this.

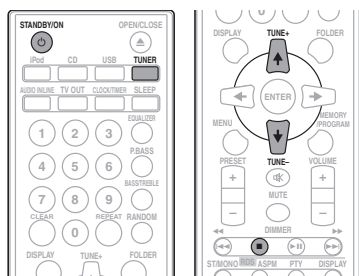

Tuning

- 1 Press the **STANDBY/ON** to turn the power on.
- 2 Press **TUNER** repeatedly to select desired frequency band (FM or AM).
- 3 Press **TUNE +/-** on the remote control to tune in to the desired station.

Automatic tuning:

Press and hold **TUNE +/-**, scanning will start automatically and the tuner will stop at the first receivable broadcast station.

Manual tuning:

Press the **TUNE +/-** repeatedly to tune in to the desired station.



Note

- When radio interference occurs, automatic tuning may stop automatically at that point.
- Automatic tuning will skip weak signal stations.
- To stop the automatic tuning, press **■**.
- When an RDS (Radio Data System) station is tuned in, the frequency will be displayed first. Finally, the station name will appear.
- Full auto tuning can be achieved for RDS stations "ASPM", see page 26.

To receive an FM stereo transmission:

- Press **ST/MONO** to select stereo mode and "AUTO" will be displayed.

Improving poor FM reception:

1 Press ST/MONO repeatedly to select MONO.

This will change the tuner from stereo to mono and usually improve the reception.

Saving station presets

If you often listen to a particular radio station, it's convenient to have the receiver store the frequency for easy recall whenever you want to listen to that station (Preset tuning). This saves the effort of manually tuning in each time. This unit can memorize up to 45 stations.

(FM 30 stations/AM 15 stations)

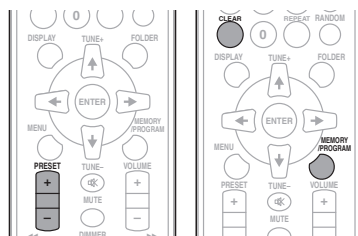

1 Tune to a station you want to memorize.

See *Tuning* above for more on this.

2 Press MEMORY/PROGRAM.

The preset number will flash.

3 Press PRESET +/- to select the preset channel number.

4 Press MEMORY/PROGRAM to store that station in memory.

If the preset number has changed from flashing to lighting, before the station is memorised, repeat the operation from step 2.

- Repeat steps 1 - 4 to set other stations, or to change a preset station. When a new station is stored in the memory, the station previously memorised for that preset channel number will be erased.



Note

- The backup function protects the memorised stations for a few hours should there be a power failure or the AC power cord become disconnected.

To recall a memorised station

- 1 Press **PRESET +/-** to select the desired station.

To scan the preset stations

The stations saved in the memory can be scanned automatically. (Preset memory scan)

- 1 Press and hold **PRESET +/-**.

The preset number will appear and the programmed stations will be tuned in sequentially, for 5 seconds each.

- 2 Press **PRESET +/-** again when the desired station is located.

To erase entire preset memory

- 1 Press **TUNER** on the remote control.
- 2 Press **CLEAR** until "MEM CLR" appears.

Note

- All stations will be erased.

Using the Radio Data System (RDS)**An introduction to RDS**

Radio Data System (RDS) is a system used by most FM radio stations to provide listeners with various kinds of information—the name of the station and the kind of show they're broadcasting, for example.

One feature of RDS is that you can search by type of program. For example, you can search for a station that's broadcasting a show with the program type, **JAZZ**.

You can search the following program types:

- NEWS** – News
- AFFAIRS** – Current Affairs
- INFO** – General Information
- SPORT** – Sport
- EDUCATE** – Educational
- DRAMA** – Radio plays, etc.
- CULTURE** – National or regional culture, theater, etc.
- SCIENCE** – Science and technology
- VARIED** – Usually talk-based material, such as quiz shows or interviews.
- POP M** – Pop music
- ROCK M** – Rock music
- EASY M** – Easy listening
- LIGHT M** – 'Light' classical music
- CLASSICS** – 'Serious' classical music
- OTHER M** – Music not fitting above categories
- WEATHER** – Weather reports
- FINANCE** – Stock market reports, commerce, trading, etc.
- CHILDREN** – Programs for children
- SOCIAL** – Social affairs
- RELIGION** – Programs concerning religion
- PHONE IN** – Public expressing their views by Phone
- TRAVEL** – Holiday-type travel rather than traffic announcements
- LEISURE** – Leisure interests and hobbies
- JAZZ** – Jazz
- COUNTRY** – Country music
- NATION M** – Popular music in a language other than English
- OLDIES** – Popular music from the '50s and' 60s
- FOLK M** – Folk music
- DOCUMENT** – Documentary
- TEST** – Broadcasting when testing emergency broadcast equipment or receivers.
- ALARM** – Emergency announcement made under exceptional circumstances to give warning of events causing danger of a general nature.

Searching for RDS programs

You can search a program type listed above.

- 1 Press **TUNER** on the remote control.
 - RDS is only possible in the FM.
- 2 Press **RDS PTY** on the remote control. "SELECT" will appear for about 6 seconds.
- 3 Press **←/→** to select the program type you want to hear.

Each time the button is pressed, the program type will appear. If the button is held down, the program type will appear continuously.
- 4 Whilst the selected program type is flashing (within 6 seconds), Press **RDS PTY** again.

After the selected program type has been lit for 2 seconds, "SEARCH" will appear, and the search operation will start.

Note

- If the display has stopped flashing, start again from step 2. If the unit finds a desired program type, the corresponding channel number will lit for about 8 seconds, and then the station name will remain it.
- If you want to listen to the same program type of another station, press the **RDS PTY** whilst the channel number or station name is flashing. The unit will look for the next station.
- If no station can be found, "NOT FOUND" will appear for 4 seconds.

Information provided by RDS

Each time the **RDS DISPLAY** is pressed, the display will switch as follows:

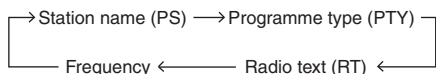
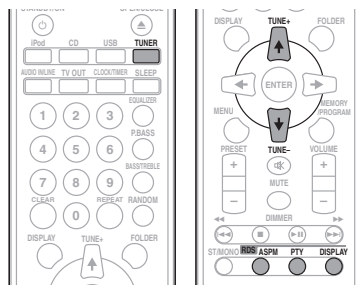

When tuning in to a station other than an RDS station or to an RDS station which sends weak signal, the display will change in the following order:

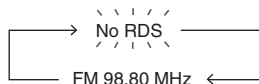

Using the Auto Station program Memory (ASPM)

Whilst in the ASPM operation mode, the tuner will automatically search for new RDS stations. Up to 30 stations can be stored.

If you have already stored some stations in memory, the number of new stations you can store will be less.

1 Press TUNER on the remote control.

2 Press and hold down RDS ASPM on the remote control.

After "**ASPM**" has flashed for about 4 seconds, scanning will start (87.5 - 108 MHz).

After scanning, the number of stations stored in memory will be displayed for 4 seconds, and then "END" will appear for 4 seconds.

To stop the ASPM operation before it is complete:

Press **■** whilst it is scanning for stations. The stations which are already stored in memory will be kept there.

Note

- If the same station is broadcasting on different frequencies, the strongest frequency will be stored in memory.
- Any station which has the same frequency as the one stored in memory will not be stored.
- If 30 stations have already been stored in memory, the scan will be aborted. If you want to redo the ASPM operation, erase the preset memory.
- If no station have been stored in memory, "END" will appear for about 4 seconds.
- If the RDS signals are very weak, station names may not be stored in memory.
- The same station name can be stored in different channels.
- In a certain area or during certain time periods, the station names may temporarily be different.

Notes for RDS operation

If any of the following events occur, it does not mean that the unit is faulty:

- "PS", "No PS" and a station name appear alternately, and properly.
- If a particular station is not broadcasting properly or a station is conducting tests, the RDS reception function may not work properly.
- When you receive an RDS station whose signal is too weak, information like the station name may not be displayed.
- "No PS", "No PYT" or "No RT" will flash for about 5 seconds, and then the frequency will be displayed.

Notes for radio text:

- The first 8 characters of the radio text will appear and then they will scroll across the display.
- If you tune in to an RDS station which is not broadcasting any radio text, "No RT" will be displayed when you switch to the radio text position.
- Whilst radio text data is received or when the text contents change, "RT" will be displayed.

Chapter 9: Other connections

⚠ CAUTION

- Before making or changing the connections, switch off the power and disconnect the power cord from the AC outlet.

Connecting auxiliary components

Connect the front panel **AUDIO IN** mini-plug jack to your auxiliary playback component.

- This method can be used to play music on this unit from iPods/iPhones/iPads that do not support use of an iPod Dock and USB terminal.

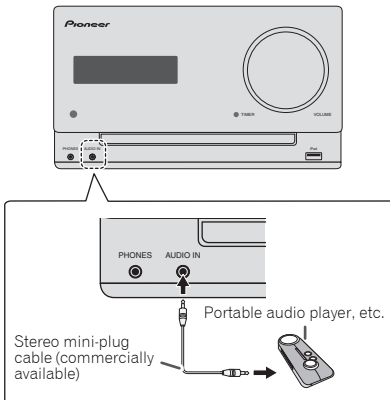

1 Press AUDIO IN/LINE as the input source.

When **AUDIO IN** is selected, "AUDIO IN" is displayed on the main display.

🔧 Note

- If the **AUDIO IN** mini-plug jack is connected to auxiliary phones jack, the volume of the unit will be adjusted by the volume on the playback component. If the sound is distorted after you lower the volume of the unit, try lowering the volume on the auxiliary playback component.

Connect the rear panel **LINE IN** audio jacks to your auxiliary playback component.

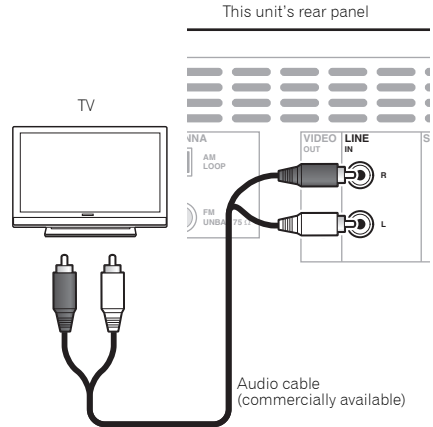

1 Press AUDIO IN/LINE twice as the input source.

When **LINE** is selected, "LINE" is displayed on the main display.

Chapter 10:

Additional information

Troubleshooting

Incorrect operations are often mistaken for trouble and malfunctions. If you think that there is something wrong with this component, check the points below. Sometimes the trouble may lie in another component. Investigate the other components and electrical appliances being used. If the trouble cannot be rectified even after exercising the checks listed below, ask your nearest Pioneer authorized service center or your dealer to carry out repair work.

- If the unit does not operate normally due to external effects such as static electricity disconnect the power plug from the outlet and insert again to return to normal operating conditions.

General problem

Problem	Check	Remedy
Settings you have made have been cleared.	Was the power cord unplugged?	When power cord is unplugged, the settings you have made is cleared. Please set the clock again. If you do not want to clear the settings, do not unplug the power cord.
Difference in volume between CDs, MP3, WMA, iPod/iPhone/iPad, Tuner, AUDIO IN and LINE .	This is not a problem with this unit.	The volume may sound differently depending on the input source and recording format.
This unit cannot be operated with the remote control.	Are you operating from far away?	Operate within 7 m, 30° of the remote sensor on the front panel (page 5).
	Is the remote control sensor exposed to direct sunlight or strong artificial light from a fluorescent bulb, etc.?	The remote control signals may not be received properly if the remote control sensor is exposed to direct sunlight or strong artificial light from a fluorescent bulb, etc.
	Are the batteries dead?	Replace the batteries (page 5).
Disc cannot be played or disc is ejected automatically.	Is the disc scratched?	Scratched discs may not play.
	Is the disc dirty?	Wipe the dirt off the disc (page 31).
	Is this unit placed in a humid location?	There could be condensation inside. Wait a while for the condensation to evaporate. Do not place this unit near an air-conditioner, etc. (page 31).
Folder or file names are not recognized.	Have you exceeded the maximum number of folder or file names this unit can recognize?	Up to 255 folders can be recognized on one disc. Up to 999 files can be recognized within one folder. Depending on the folder structure, however, this unit may not be able to recognize certain folders or files.
The unit turns off automatically.		If no play back and no operation has done for 15 minutes or more, the unit turns off automatically.

When a USB storage device is connected

Problem	Check	Remedy
USB storage device is not recognized.	Is the USB storage device properly connected?	Connect the device securely (all the way in).
	Is the USB storage device connected via a USB hub?	This unit does not support USB hubs. Connect the USB storage device directly.
		This unit only supports USB mass storage class devices.
		This unit supports portable flash memory and digital audio playback devices.
		Only the FAT16 and FAT32 file systems are supported. Other file systems (exFAT, NTFS, HFS etc.) are not supported.
	This device does not support the use of external hard disc drives.	
	This is not a problem with this unit.	Turn the power off then back on. Some USB storage devices may not be recognized properly.
File cannot be played.	Is the file copyright-protected (by DRM)?	Copyright-protected files cannot be played.
	This is not a problem with this unit.	Files stored on a computer cannot be played. It may not be possible to play some files.
Folder or file names are not displayed or are not properly displayed.	Do the folder or file names contain more than 30 characters?	The maximum number of characters displayable for the folder and file names is 30.
Folder or file names are not displayed in alphabetical order.	This is not a problem with this unit.	The order of the folder and file names displayed depends on the order in which the folders or files were recorded on the USB storage device.
Much time is required to recognize the USB storage device.	What is the USB storage devices capacity?	Some time may be required to load the data when large capacity USB storage devices are connected (this could take several minutes).
Power is not supplied to the USB storage device.	Is AUTH ERR displayed on the front panel display? No power is supplied if the power consumption is too high.	Turn the power off then back on.
		Turn the power off, then disconnect and reconnect the USB storage device. Press INPUT to switch to the other mode, then switch again to the USB mode.

When an iPod/iPhone/iPad is connected

Problem	Remedy
Can't operate the iPod/iPhone/iPad by the remote control.	Make sure the iPod/iPhone/iPad is connected correctly (refer to <i>Connecting your iPod/iPhone/iPad</i> on page 15).
Can't operate the iPod/iPhone/iPad.	Make sure the iPod/iPhone/iPad is connected correctly (refer to <i>Connecting your iPod/iPhone/iPad</i> on page 15). If the iPod/iPhone/iPad is experiencing a hangup, try resetting the iPod/iPhone/iPad, and reconnect it to the unit.

Playable discs and formats

Audio CD	<ul style="list-style-type: none"> • Commercially available audio CDs • CD-R/ -RW/ -ROM discs containing music recorded in the CD-DA format
WMA	WMA files recorded on CD-R/ -RW/ -ROM discs or USB storage devices
MP3	MP3 files recorded on CD-R/ -RW/ -ROM discs or USB storage devices

- **Only the discs that have been finalized can be played.**
- Discs recorded in packet write mode (UDF format) are not compatible with this unit.
- Corporation and product names mentioned herein are trademarks or registered trademarks of the respective corporations.
- Only discs recorded in ISO9660 Level 1, Level 2 and Joliet can be played.
- Files protected by DRM (Digital Rights Management) cannot be played.



Note

- This unit does not support multisession discs or multiborder recording.
- Multisession/multiborder recording is a method in which data is recorded on a single disc in two or more sessions/borders. A "session" or "border" is one recording unit, consisting of a complete set of data from lead-in to lead-out.

Regarding copy protected CDs

This unit is designed to conform to the specifications of the audio CD format. This unit does not support the playback or function of discs that do not conform to these specifications.

Supported audio file formats

- This unit does not support lossless encoding.

Cautions on use

When moving this unit

When moving this unit, be sure to first check that there is no disc loaded and disconnect the iPod/iPhone/iPad. Then press **⏻** **STANDBY/ON**, wait for "**STANDBY**" disappears on main display to turn off, then unplug the power cord. Damage may occur if the unit is transported or moved with a disc inserted, or when another device is connected to the iPod/iPhone/iPad connector port, USB terminal, or **AUDIO IN** mini-plug jack.

Place of installation

- Choose a stable place near the TV or stereo system being used with this unit.
- Do not place this unit on top of a TV or color monitor. Also install it away from cassette decks and other devices easily affected by magnetic forces.

Avoid the following locations:

- Places exposed to direct sunlight
- Humid or poorly ventilated places
- Extremely hot places
- Places exposed to vibrations
- Places in which there is much dust or cigarette smoke
- Places exposed to soot, steam or heat (kitchens, etc.)

Do not place objects on this unit

Do not place any objects on top of this unit.

Do not obstruct the ventilation holes.

Do not use this unit on shaggy rugs, beds, sofas, etc., or wrapped in cloth, etc. Doing so will prevent the heat from dispersing, leading to damage.

Do not expose to heat.

Do not place this unit on top of an amplifier or other component that generates heat. When rack mounting it, to avoid the heat given off by the amplifier or other audio component, place it on a shelf below the amplifier.

- Turn off the unit's power when not using it.
- Depending on signal conditions, striped patterns may appear on a TV screen and noise may enter the sound of radio broadcasts when the unit's power is on. If this happens, turn the unit's power off.

About condensation

If this unit is moved suddenly from a cold place into a warm room (in winter, for example) or if the temperature in the room in which this unit is installed rises suddenly due to heater operation, etc., water droplets (condensation) may form inside (on operating parts and the lens). When condensation is present, this unit will not operate properly and playback is not possible. Let this unit stand at room temperature for 1 or 2 hours with the power turned on (the time depends on the extent of condensation). The water droplets will dissipate and playback will become possible. Condensation can also occur in the summer if this unit is directly exposed to the air flow from an air-conditioner. If this happens, move this unit to a different place.

Cleaning the product

- Unplug the power cord from the power outlet when cleaning this unit.
- Clean this unit using a soft cloth. For tough dirt, apply some neutral detergent diluted in 5 to 6 parts water to a soft cloth, wring out thoroughly, wipe off the dirt, then wipe again with a soft, dry cloth.
- Alcohol, thinner, benzene, insecticides, etc., could cause the print or paint to peel off. Also, leaving rubber or vinyl products in contact with this unit for long periods of time could mar the cabinet.
- When using chemical-impregnated wipes, etc., read the cautions included with the wipes carefully.

Cleaning the lens

- This unit's lens should not become dirty in normal use, but if for some reason it should malfunction due to dust or dirt, consult your nearest Pioneer authorized service center. Although lens cleaners for players are commercially available, we advise against using them since some may damage the lens.

Handling discs**Storing**

- Always place discs in their cases and store them vertically, avoiding hot, humid places, places exposed to direct sunlight and extremely cold places.
- Be sure to read the cautions included with the disc.

Cleaning discs

- Discs may not play if there are fingerprints or dust on them. In this case, use a cleaning cloth, etc., to gently wipe the disc from the inside towards the outside. Do not use dirty cleaning cloths.

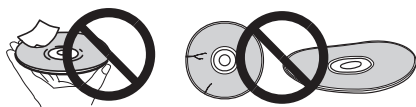

- Do not use benzene, thinner or other volatile chemicals. Also do not use record spray or antistatic agents.
- For tough dirt, apply some water to a soft cloth, wring out thoroughly, wipe off the dirt, then wipe off the moisture with a dry cloth.
- Do not use damaged (cracked or warped) discs.
- Do not let the signal surface of discs get scratched or dirty.
- Do not attach pieces of paper or stickers to discs. Doing so could warp discs, making it impossible to play them. Also note that rental discs often have labels attached to them, and the label's glue may have oozed out. Check that there is no glue around the edges of such labels before using rented discs.

**About specially shaped discs**

Specially shaped discs (heart-shaped, hexagonal, etc.) cannot be played on this unit. Do not attempt to play such discs, as they could damage this unit.



About iPod/iPhone/iPad







"Made for iPod" and "Made for iPhone" and "Made for iPad" mean that an electronic accessory has been designed to connect specifically to iPod, iPhone, or iPad, respectively, and has been certified by the developer to meet Apple performance standards. Apple is not responsible for the operation of this device or its compliance with safety and regulatory standards. Please note that the use of this accessory with iPod, iPhone or iPad may affect wireless performance.

iPad, iPhone, iPod, iPod nano and iPod touch are trademarks of Apple Inc., registered in the U.S. and other countries.

Restoring all the settings to the defaults

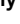
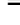
Use the steps below to restore the all settings to their defaults.

- 1 Press  STANDBY/ON to turn the power on.**
- 2 Press  on the remote control or INPUT repeatedly on the main unit to select CD input.**
- 3 Press  OPEN/CLOSE to open the disc tray.**
- 4 Press  STANDBY/ON while pressing .**

Use the buttons on this unit's top panel. "DEFAULT" is displayed while the settings are being restored. Power is turned off.

Specifications

- Amplifier section**

RMS Power Output: 15 W + 15 W
(1 kHz, 10 %, T.H.D., 8 Ω)

- Tuner section**

Frequency Range (FM) 87.5 MHz to 108 MHz
Antenna Input (FM) 75 Ω unbalanced
Frequency Range (AM) 522 kHz to 1620 kHz
Antenna (AM) Loop antenna

- Miscellaneous**

iPod/iPhone connector port 5 V, 1 A
USB terminal 5 V, 2.1 A
Power source AC 220 V to 240 V, 50 Hz/60 Hz
Power consumption
Power on 37 W
Power stand-by 0.5 W or less
Dimensions 200 mm (W) x 123 mm (H) x 250.6 mm (D)
Weight (without package) 2.0 kg

- Speaker**

Magnetically shielded speaker system
Type
2-way type speaker system
5 cm Tweeter
9.4 cm Woofer
Maximum input power 15 W
Impedance 8 Ω
Dimensions 120 mm (W) x 200 mm (H) x 232.6 mm (D)
Weight 2.0 kg/each

- Accessories**

Remote control 1
AAA batteries (R03) 2
AM antenna cable 1
FM wire antenna 1
Non-skid pads 8
Power cord
iPad Stand
Warranty card
Operating instructions (This document)

 **Note**

- The specifications are applicable when the power supply is 230 V.
- Specifications and the design are subject to possible modifications without notice, due to improvements.

© 2012 PIONEER CORPORATION.
All rights reserved.

